

- Safe and easy maintenance to minimize the work on site.
- Uv Printed front panel is highly sustainable and clear
- Power supply is secured with Fail Open.
- The power supply is installed outside the panel for easy maintenance.

► **MATERIALS AND FINISH**

- Body : Aluminum extrusions, panels, corner leg supports and mounting legs
- Panel : long-life polycarbonate, UV and abrasion resistant
- Stainless steel hardware

CONSUMPTIONS	
Length	Power
900 - 600mm	30W
1300 - 950mm	40W
1650 - 1350mm	50W
1850 - 1700mm	60W
2250 - 1900mm	70W
2550 - 2300mm	80W
2800 - 2600mm	90W
3000 - 2850mm	100W

► **COMPLIANCE**

- FAA** AC 150/5345-44
- ICAO** Annex - 14 Vol.1 Para5.4 & Appendix 4

► **APPLICATIONS**

- On civil or military airports as;
- Mandatory Instruction Signs
 - Information Signs
 - VOR Check Point Signs
 - Runway Distance Remaining Signs
 - Arresting Barrier Signs

► **BENEFITS**

- Highly visible in all weather conditions
- Supplied fully assembled
- Special design features for ease of maintenance
- Extruded aluminum profile
- UV stabilized 4mm polycarbonate
- Weather-proof to IP54
- Temperature range of -25°C to +55°C
- Setting of panel character, intensity, evenness and chromaticity achieved ICAO Annex 14.
- Modular design on each function is easy maintenance.
- Excellent performance and lower energy consumption reduce the operation cost.
- Panel can be open till take out of the fixture to process the internal clean.
- Free tool front door open design.
- Frangibility according to ICAO or FAA requirements

► **MAIN COMPONENTS OF THE LIGHT UNIT**

- 1 : Upper Cap
- 2 : Upper Frame
- 3 : Upper Cover
- 4 : Side Frame
- 5 : Face (Front Panel)
- 6 : Glands & Switch
- 7 : Back Plate
- 8 : Led Bars
- 9 : Lower Frame
- 10 : Airfield Sign Board
- 11 : Pole
- 12 : Pole Holder
- 13 : Base Plate
- 14 : LED Holder

** Refer to the relevant technical manual for the complete list of the available spare parts*

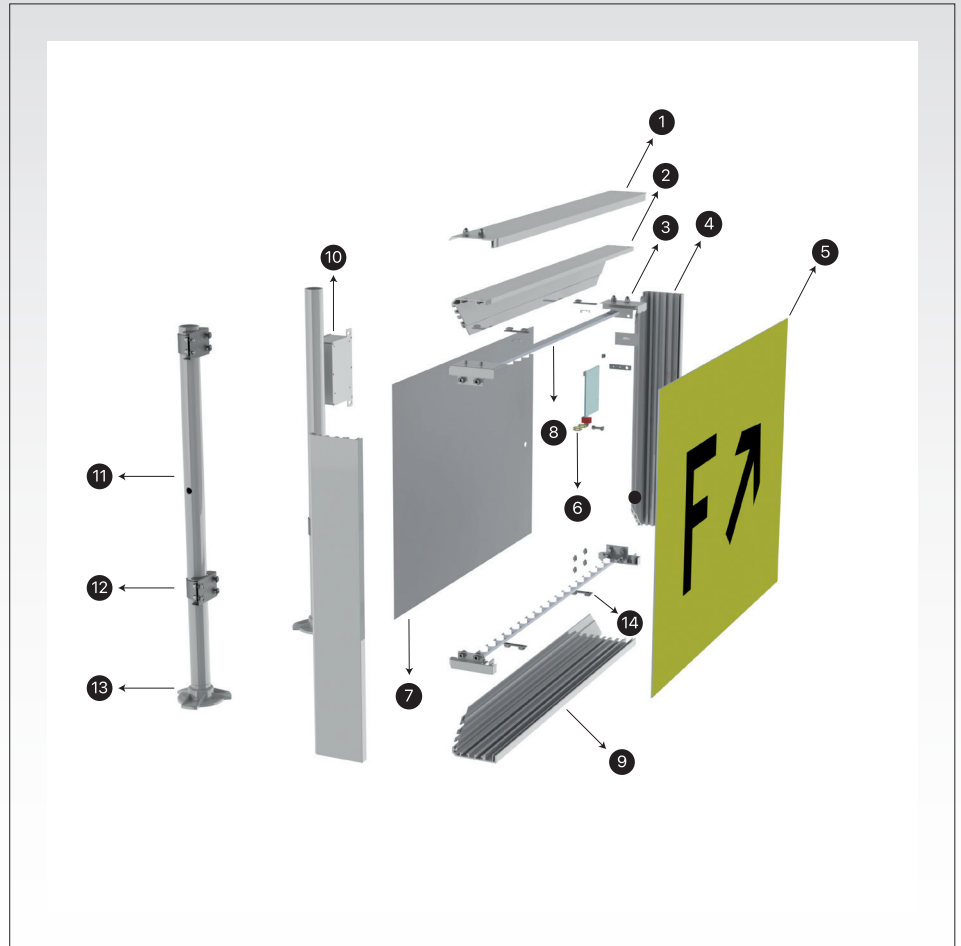

DIMENSIONS

Width	135mm
Height	846mm (Message Size 3) - 646mm (Message Size 4)
Length (3000-600)mm	{ 641, 691, 741, 791, ..., 2941, 2991, 3041 } mm

